

# Bever Park - Old McDonalds Farm Duck Ponds ADA Concrete

Contract No. 307304

# Utility & Emergency Numbers

Parks & Recreation Department 319-286-5750

Police Department 319-286-5491

**Fire Department** 319-286-5200

Emergency 911

Alliant Energy  
319-786-1912

Mid American Energy 319-298-5155

Water Department 319-286-5910

**Qwest Communications** 319-399-7600

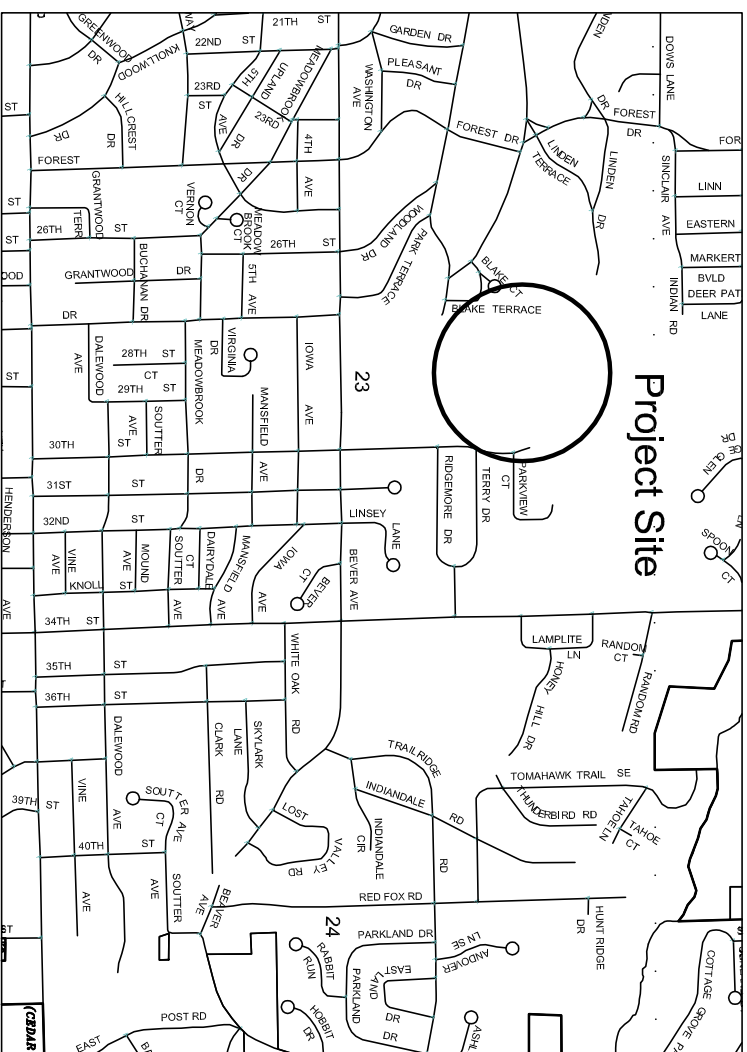

## Location Map

Not to Scale

Mayor: Brad Hart

# City Council

# Susie Weinacht

# Ann Poe

Tyler Olson

# Marty Hoeger

# Scott Overland

**Dale Todd**

# Scott Olson

# Ashley Vanorny

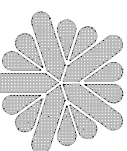

CEDAR RAPIDS

City Of Five Seasons

Sheet Index
1
Cover Sheet
ADA Concrete Updates

I hereby certify that this document was prepared by me or under my direct personal supervision and that I am a duly Licensed Landscape Architect under the laws of the State of Iowa.

Stephen J. Krug  
Krug  
340

LICENSED LANDSCAPE ARCHITECT  
IOWA

---

Stephen J. Krug Iowa Reg No. 340

My License renewal date is June 30, 2020

Pages covered by this seal: \_\_\_\_\_





# Hidden Park Restroom Facility

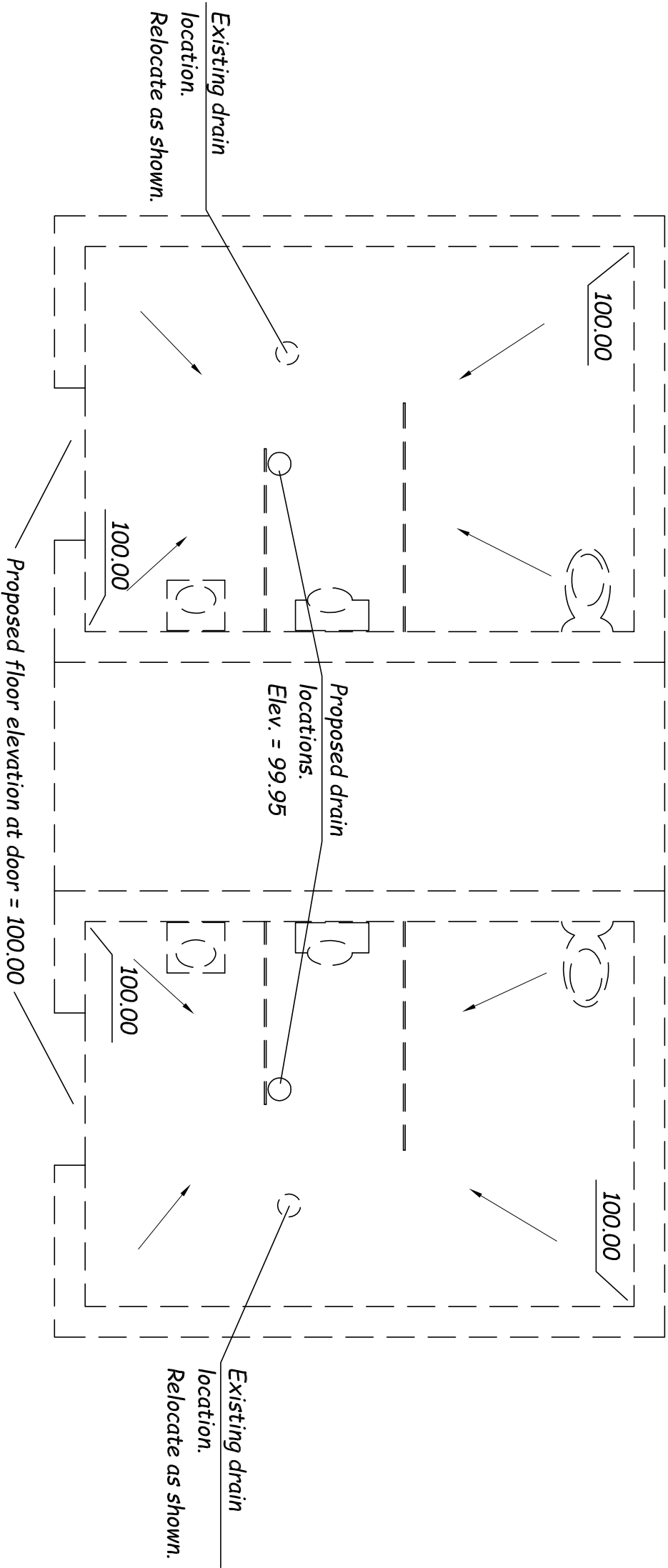

## Demolition Notes

- Contractor shall remove existing restroom fixtures and partitions that will be in the way of re-pouring the restroom floors. Contractor shall store removed fixtures and partitions and re-install in the same location as removed. Verify ADA dimensions upon re-installation and adjust as necessary.
- Contractor shall full-depth saw-cut the existing floor as close as possible to the existing wall. Remove existing concrete floor and dispose of debris off-site.
- Contractor and Owner shall walk through before construction begins to verify the condition of the existing facility. Damage to existing facility, fixtures and partitions that is not accounted for in the walk through shall be repaired by the contractor at the contractor's expense to the satisfaction of the Owner.

## Construction Notes

- Contractor shall re-grade and compact sub-base material as needed.
- Install #4 re-bar 12-inches long, 18-inches O.C. drilled into existing flooring along the walls. Drill re-bar into existing a minimum of 4-inches deep, centered in depth of existing concrete.
- Re-locate existing floor drain as shown on plans.
- Place new 4-inch PC Concrete floor as shown on plans. PC Concrete be a C-4 mix with fibermesh added per manufacturer's specifications.
- PC Concrete shall match existing elevation around outside walls (100.00) and slope to relocated floor drain (99.95). Maximum slope of any part of the new PC Concrete floor shall not exceed 1.5% slope. Adjust floor drain if needed.
- Match existing concrete floor at walls with smooth joint at surface.
- PC Concrete surface to be a steel trowel finish.